

Changing the Current

The world is ready for the next paradigm shift.



ENERGY

THE WORLD IS CONSUMING IT FASTER THAN IT CAN BE FOUND. AND THE TIME HAS COME FOR WIND POWER TO MOVE TO THE FOREFRONT. UNTIL RECENTLY, GENERATING WIND POWER HAD BEEN PRIMARILY LIMITED TO SPACIOUS, UNDEVELOPED RURAL AREAS, LARGE ENOUGH TO ACCOMMODATE CONVENTIONAL TURBINES. BUT BROADSTAR WIND SYSTEMS™ IS MAKING WIND ENERGY A VIABLE, COST-EFFECTIVE OPTION FOR BUSINESSES AND GOVERNMENT ENTITIES OF ALL SIZES, IN A VARIETY OF ENVIRONMENTS. HOW? WITH THE BROADSTAR AEROCAM™ – A BREAKTHROUGH TURBINE TECHNOLOGY THAT ENABLES DISTRIBUTED POWER GENERATION IN ALMOST ANY SETTING, FROM DENSE URBAN ENVIRONMENTS AND UNCONVENTIONAL SITES, SUCH AS COMMERCIAL DEVELOPMENTS AND CORPORATE CAMPUSES, TO NEW AND EXISTING WIND FARMS BOTH LARGE AND SMALL. QUITE SIMPLY, BROADSTAR IS UNLEASHING A NEW WAY FOR EVERYONE TO HARNESS WIND ENERGY. BECAUSE THE WORLD IS READY FOR THE NEXT PARADIGM SHIFT. ARE YOU?

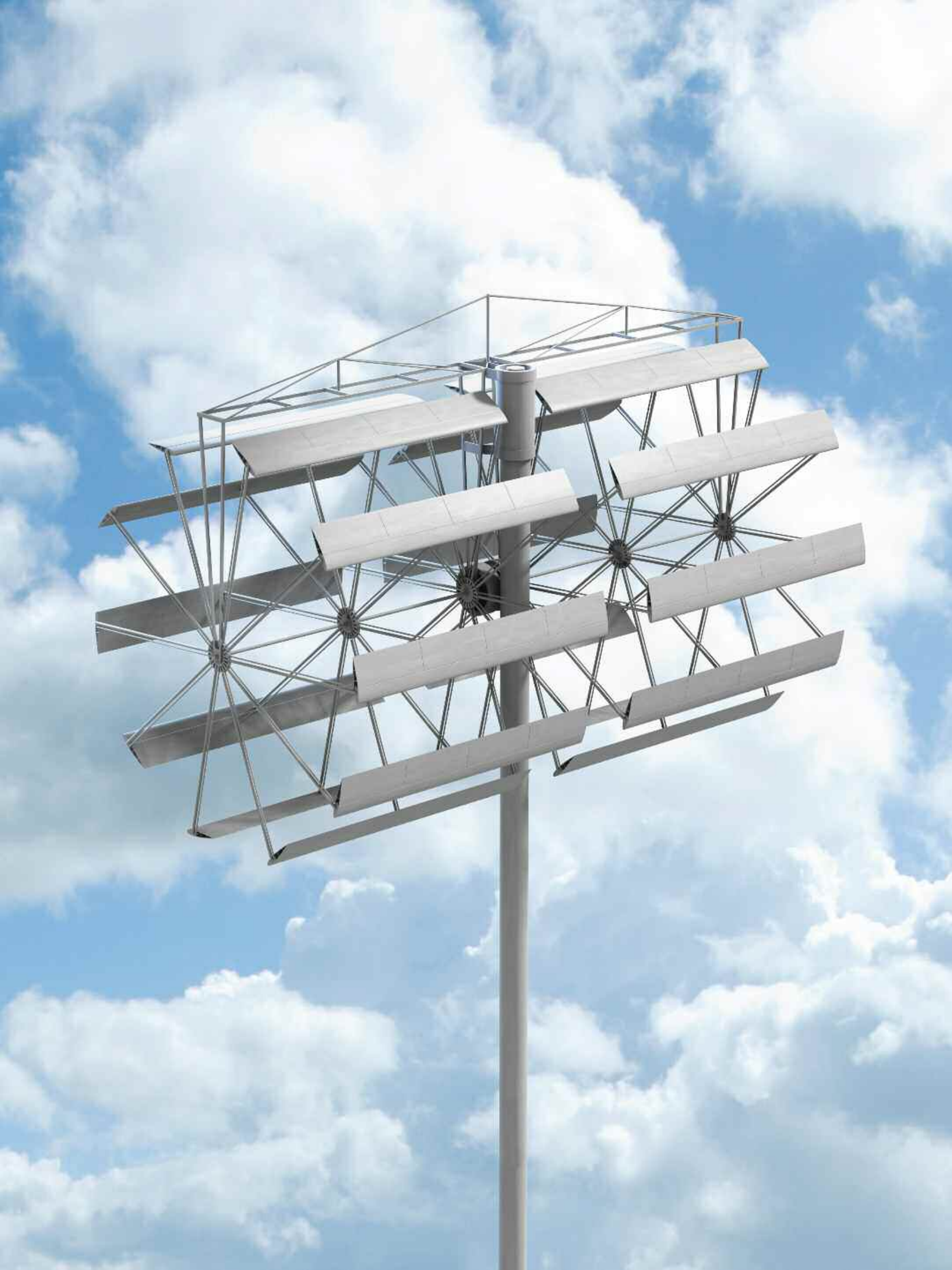

What makes the BroadStar AeroCam different?

The AeroCam is intelligent science.

The science behind the BroadStar AeroCam is brilliant in its simplicity.

In the same way that an airplane wing uses the movement of air to generate a force powerful enough to raise an enormous aircraft and keep it airborne, the AeroCam captures energy from wind with incredible efficiency. The patented* design features aerodynamic blades that use the natural flow of air to create lift, and an offset cam that allows the blades to continually adjust for optimal pitch throughout a 360° rotation of the turbine. As a result, the AeroCam is approximately 30 percent smaller yet generates the same power when compared to conventional horizontal axis wind turbines (HAWTs).

The AeroCam is redefining the wind industry.

With its unique, patented design, BroadStar's AeroCam is

changing the landscape of what's possible for wind energy. Because it adapts easily to changes in wind direction and extremes of wind speed, the AeroCam can easily handle highly turbulent environments that are problematic for conventional HAWTs. Plus, the AeroCam's smaller footprint makes wind power generation possible in locations that are unthinkable for large turbines. Additionally, no special cranes are required for installation, which means an AeroCam system is much easier and less expensive to implement and maintain. All combined, it adds up to a solution that delivers more power, flexibility, and reliability – all with a lower total cost of ownership and faster time to payback.

From urban environments to wind farms, BroadStar's patented, lift-based AeroCam is delivering a whole new way to access wind energy.

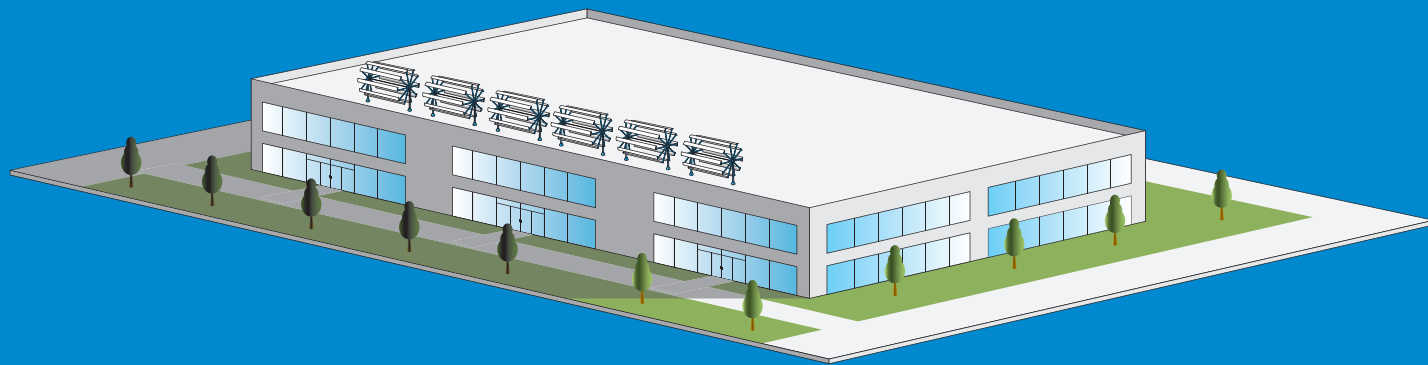

The AeroCam's smaller footprint, lower hub height, and optional architectural enclosures make it easy to place on rooftops – both on high-rise structures in urban settings and low-rise buildings, such as retail malls or corporate sites.

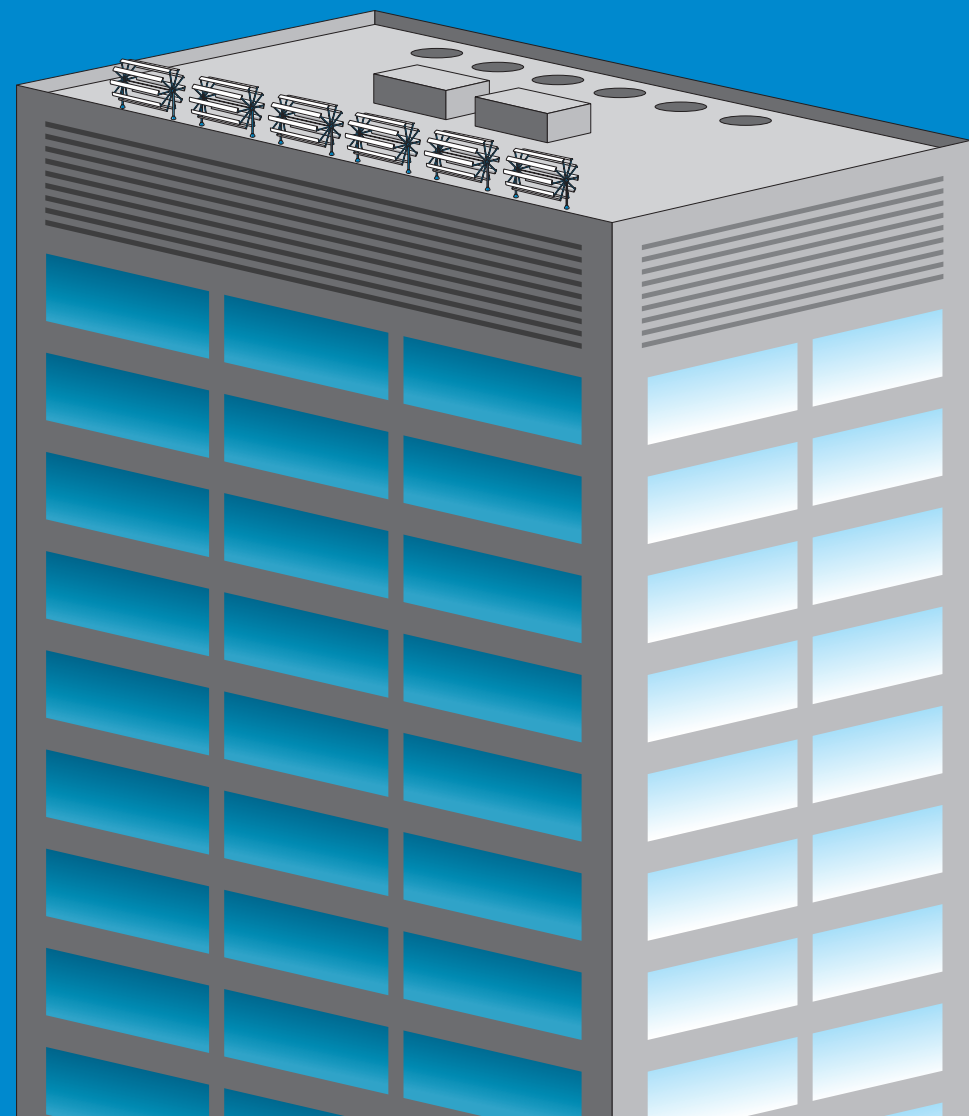

Urban wind power generation? How is that possible?

The AeroCam makes every high rise a potential generation station.

Until now, entering the wind energy market

has been prohibitive due to the real estate requirements; cost to purchase, install, and maintain turbines; and noise, size, and visual pollution associated with conventional HAWTs. The BroadStar AeroCam, however, is pioneering a new market for power generation – urban wind. Within the canyons of typical downtown environments, powerful wind drafts are created as the air hits building surfaces and moves upward. The AeroCam is ideal for placement atop familiar and abundant urban structures, such as high-rise buildings, commercial rooftops, and parking garage structures. It is small enough to fit easily around rooftop perimeters, capturing the wind currents at their point of highest velocity. Some AeroCam models can reliably extract energy from currents as gentle as 4 mph to winds in excess of 80 mph.

The physics of airflow make the AeroCam ideal for low-rise buildings.

The AeroCam is also an ideal power

generation solution for low-rise urban and suburban environments, such as office buildings, warehouse complexes, corporate or college campus structures, shopping malls, and freestanding retail sites. To optimize both energy generation and aesthetics, the AeroCam can be concealed within architectural enclosures that may be used to concentrate airflows to increase the wind speed – producing even greater energy productivity and efficiency and, as a result, deliver a faster return on investment.

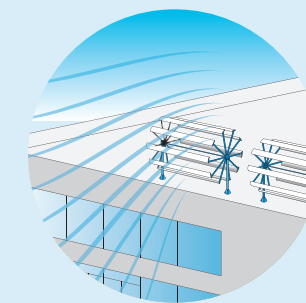

Wind gains velocity as it hits the building's surface and moves upward to the roof, where the AeroCam captures and utilizes it to generate power.

Can the BroadStar AeroCam be used to infill traditional wind farms?

The AeroCam helps existing wind farms generate more power. Because propeller-based turbines only operate efficiently in smooth airflows, they must be placed three diameters apart, hundreds of feet above the ground, facing the prevailing wind. In an effort to generate more power from the same amount of land, many of today's wind farmers are installing even bigger turbines, which must be elevated higher and spaced further apart. These larger turbines pose potential problems for commercial and military radar and bird migratory patterns, while also increasing visual and noise pollution. Because the AeroCam features a lower hub height and smaller footprint, it can withstand turbulent environments – offering a practical, economical way to infill existing farms for greater overall power generation. Using its patented lift-based design, the AeroCam captures abundant surface-wind energy without disrupting the airflows that larger turbines need to operate effectively. Plus, the AeroCam can be installed and maintained without the use of cranes or special equipment, making it easier and less expensive to maintain.

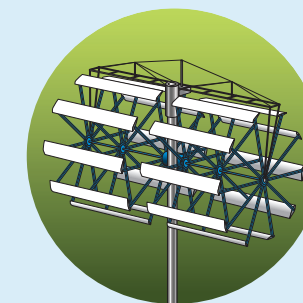

Unlike conventional turbines, the AeroCam's mast can be raised and lowered without the use of cranes, making it easier and less expensive to install and maintain.

Can the BroadStar AeroCam be used to create micro-wind farms?

The AeroCam is ideal for micro-wind farms.

With its smaller footprint, the AeroCam helps overcome barriers to developing new micro-wind farms. It requires less real estate overall, plus AeroCam turbines can be installed much closer together for a higher power yield per square mile than conventional turbines. Because the AeroCam can be installed on a pole as low as 30 feet in the air, a productive micro-wind farm can be established while still providing land owners access to ground space for farming or ranching, and without posing interference with commercial and military radar. The lower height also makes installation and maintenance possible without special cranes or equipment.

The AeroCam helps municipalities economically create their own power.

In the same way that traditional electricity utilities store and move their power along a grid, "green" energy providers also funnel their generated power into this infrastructure. Unfortunately, sometimes more power is created than can be used or stored, causing bottlenecks that compromise the delivery of lower-cost kilowatts. Traditionally, smaller municipalities have had limited access to this lower-cost power, as well as few options to produce their own, due to the inherent restrictions of conventional HAWTs. The AeroCam makes it easier for municipalities to establish their own micro-wind farms, and in fact, many states are now offering incentives and tax benefits to install renewable energy solutions. Far more economical than most other available solutions, including solar, the AeroCam enables communities of all sizes to more easily and cost-effectively establish their own local power generation source or offset the energy they purchase from the grid. And through net metering, communities can tap into new revenue streams by selling any excess wind power they generate back to the electric utility. Additionally, the AeroCam's smaller footprint and highly efficient lift-based design make it perfect for placement in a variety of settings – from low-rise commercial buildings and shopping malls to city parks.

Because the AeroCam requires much less space, it can easily be used to establish new wind farms or infill existing ones for even greater energy output.

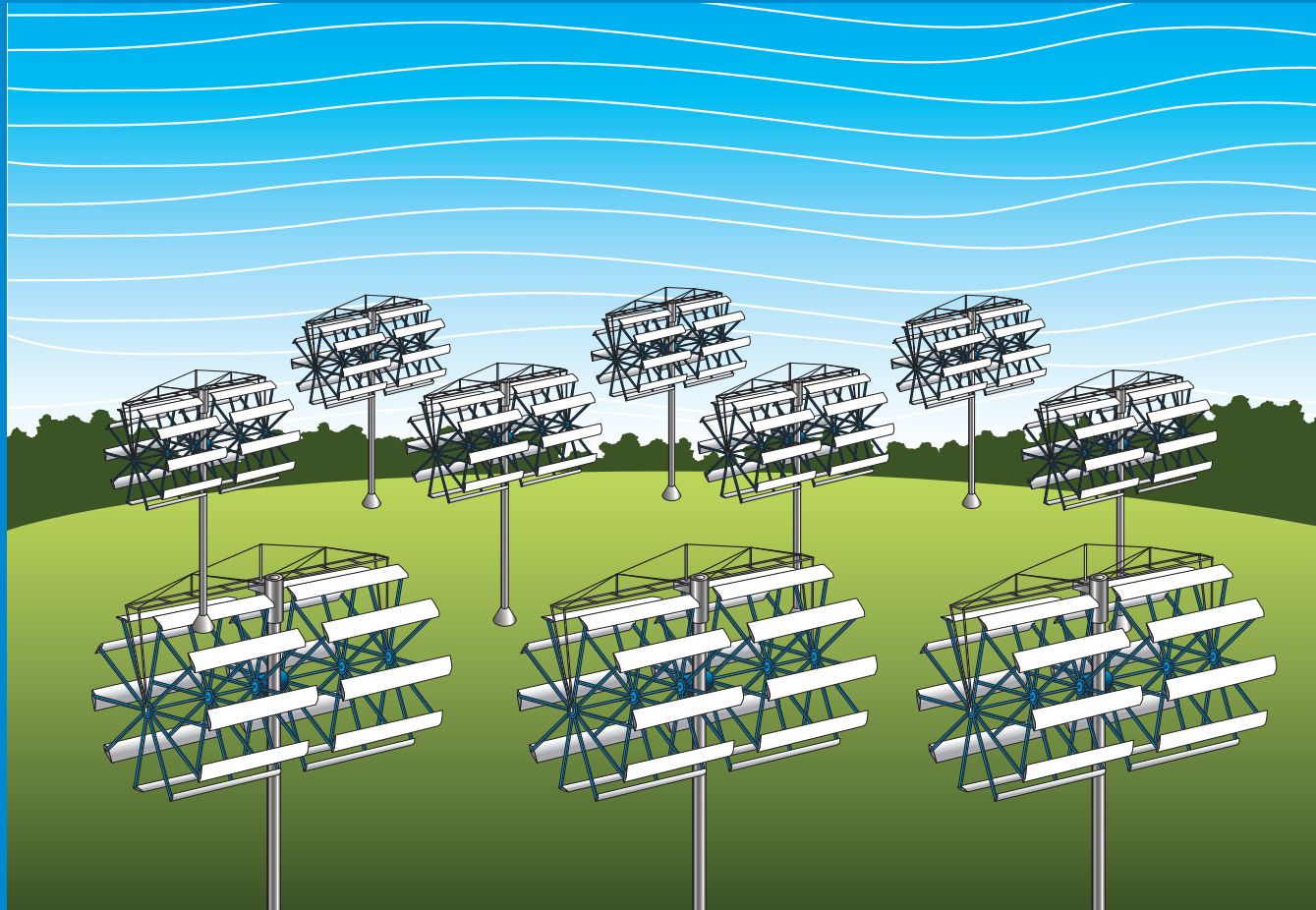

Who's ready for the next paradigm shift?

BroadStar is. With decades of proven experience in mechanical engineering, technology, and supply chain management, the BroadStar Wind Systems team has the scientific knowledge, proven and patented solution, and unwavering commitment to redefine energy production and deliver the next generation of reliable, sustainable power.

The world is. As energy costs and usage continue to increase worldwide, business and government leaders around the globe are realizing that it's time to move away from an outdated energy paradigm and move toward renewable energy sources.

Are you? To learn more about how BroadStar Wind Systems can help you, visit us online at www.broadstarwindsystems.com or call us at 214.468.8811.





BROADSTAR
W I N D S Y S T E M S